

1 CONTEXT

MacKillop College | Wyndham Vale Campus

ONE SCHOOL - THREE CAMPUSES

The new campus at Wyndham Vale provides MacKillop College with a unique opportunity to create a new Catholic Education Precinct in the Western Suburbs.

The Master Planning of the new campus should not be considered in isolation. Instead, it should be developed to compliment and augment existing facilities at the two existing campuses of MacKillop College.

Working together the cluster of campuses enable the school to strategically develop specializations at each site, maximizing value, reducing duplication and offering a unified yet diverse Catholic Education.

Students will have the chance to travel between campuses, ensuring that everyone enjoys the full breadth of the MacKillop experience.

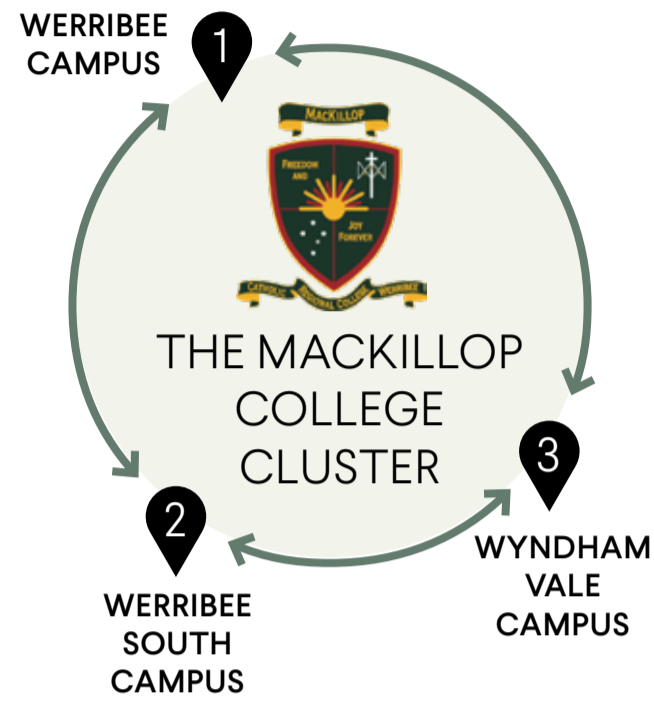

3 WYNDHAM VALE CAMPUS SITE ANALYSIS



The Wyndham Vale site is located on the lands of the Wadawurrung People, the traditional owners. Planning reports indicate an area of Aboriginal Cultural Heritage located in the north western part of the site.

The site is covered in Plains Grassland, listed as having an endangered Bioregional Conversation Status. A few established eucalyptus trees are present near the centre of the site. The site has been rezoned into an Urban Growth Zone and is part of the emerging Jubilee Estate in the Scholars Green neighbourhood. The south eastern part of the site is zoned as a Designated Bushfire Prone Area.

CONNECTIONS

The proposed school zones have been arranged to connect into their context. The proposed ELC is located near the Town Centre, the Primary & Secondary schools are centered in the site and the large school oval is adjacent to the future council sporting fields.

ROUTES

Dedicated cycle routes run to the site, allowing students to cycle to school and are set to be expanded as the estate grows. The 191 bus route runs along the western site boundary, connecting the wider estate and Wyndham Vale train station (2.9km away).

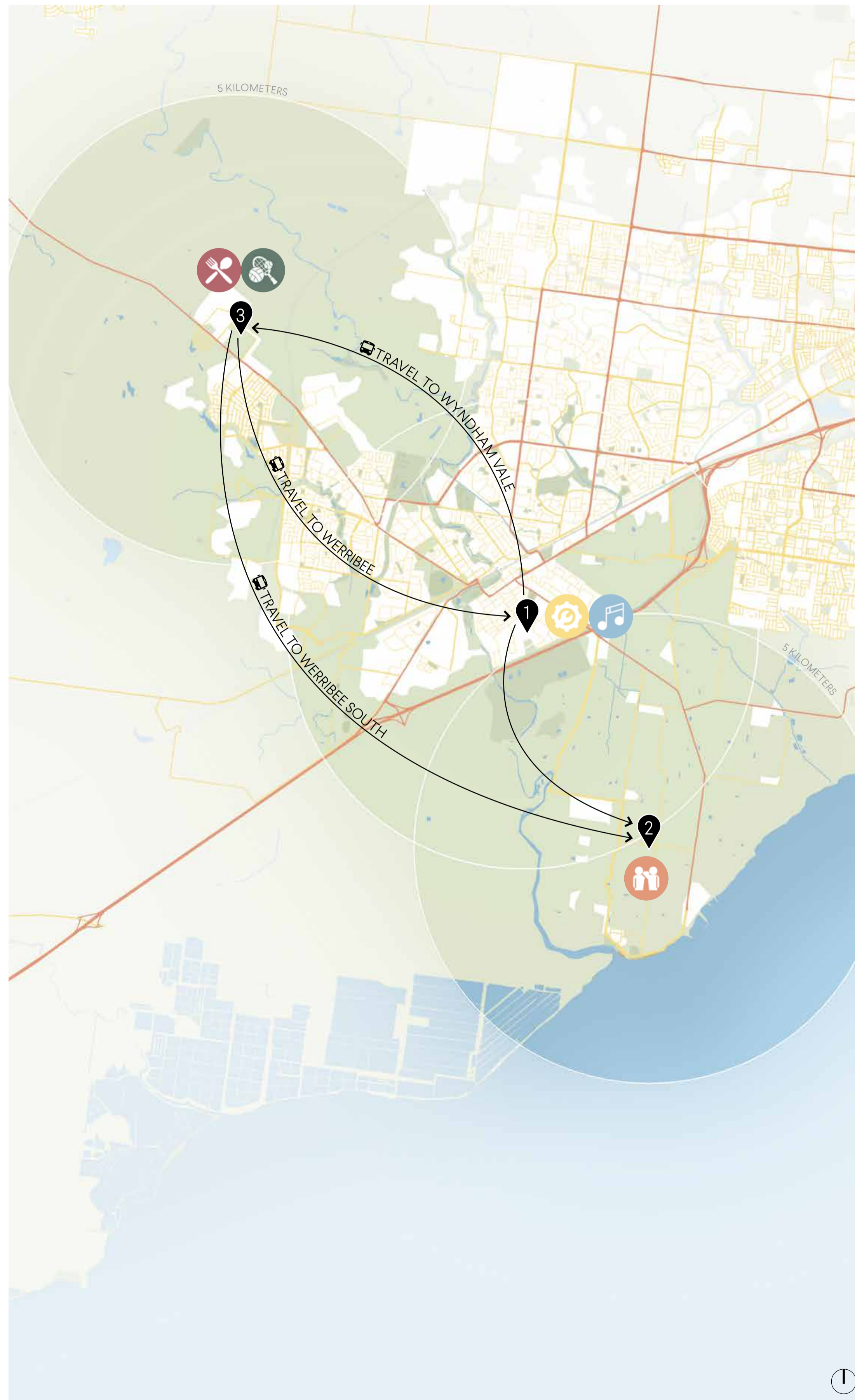
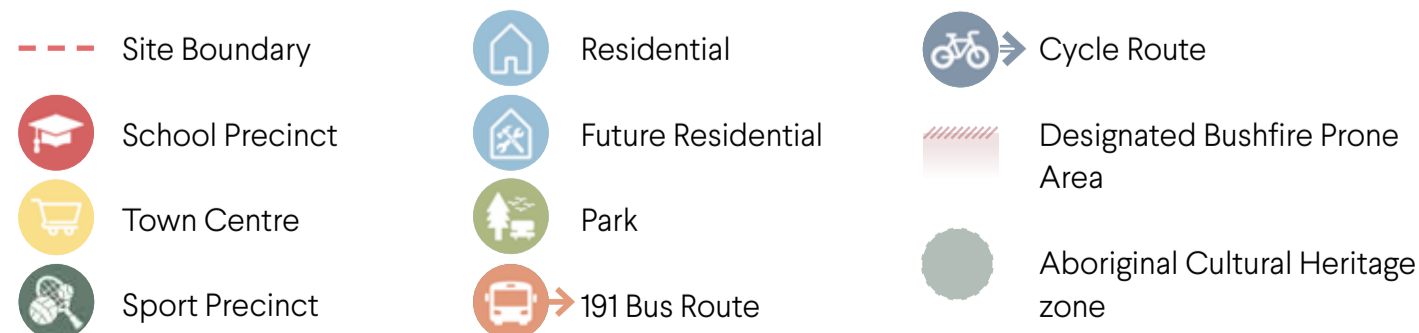

1 WERRIBEE CAMPUS

Secondary College Year 7-12
Corpus Christi Primary School on adjoining site
Total Students: 250 PREP to Year 6
1550 Year 7 to Year 12

The MacKillop College Werribee Campus is located on the original school grounds first established in 1970 as a girls secondary college. Over the years the school has expanded to enable it to offer quality Catholic education to more students.

The campus is the largest in size of the three school sites and caters to Year 7-12 students. The students are offered a comprehensive and well balanced curriculum with a broad range of units in VCE and VET. There are quality established teaching spaces for specialist subjects focusing on Design & Technology as well as a large theatre and stage for Performing Arts.



CAMPUS FOCUS:

- Design and Technology
- Performance Arts (Music / Dance / Drama)



2 WERRIBEE SOUTH CAMPUS

Year 9 Campus
Total Students: 200 Currently
250-300 Future provision

St Mary's Campus in Werribee South is a purpose built Year 9 Campus that allows students to spend 6 months of the year learning in an alternative setting. The curriculum focuses on learning through experience, engaging in meaningful community actions and inquiry based learning.

In the future, the St Mary's Campus curriculum will be offered to students from both the Werribee and Wyndham Vale Campuses to promote collaboration, interaction and fostering relationships between students.



CAMPUS FOCUS:

- Year 9



3 WYNDHAM VALE CAMPUS

ELC & Foundation - Year 12 Campus
Total Students: 99 ELC
525 PREP to Year 6 (Peak 700)
1500 Year 7 to Year 12 (Peak 1800)

The proposed new Wyndham Vale Campus offers the opportunity to expand the MacKillop Cluster and create a campus with quality, flexible & vibrant learning spaces, a careful and considered integration of nature and landscape to fosters a sense of community and belonging.

There will be a focus on providing high quality specialist facilities to teach Food Technology & Hospitality to compliment the offerings at the Werribee Campus.

Additionally a two court competition sized indoor Basketball and Netball Stadium will be developed adjacent to the community sports fields, providing Physical Education, Health, Sport and Recreation educational opportunities for MacKillop College students and the broader community alike.

CAMPUS FOCUS:

- Food Technology & Hospitality
- Sports & Recreation



2 CONCEPT

MacKillop College | Wyndham Vale Campus

CATHOLIC IDENTITY

MacKillop College is named in honor of Australia's first and only saint, St Mary MacKillop, founder of the Sisters of St Joseph of the Sacred Heart—widely known as the Josephites. Rooted in the values of a Josephite educational institution, the College's identity centres on a holistic integration of faith and learning. The new Wyndham Vale Campus will embody Catholic identity through architectural and landscape design, thoughtfully integrating Josephite values within its simple functional design, economic, low maintenance and durable material choices, incorporating natural light and addressing environmental context.

SITE

The site is currently covered in plains grassland and has several established eucalyptus trees which will be retained to form the central environmental avenue.

This landscape-led approach fosters a natural aesthetic, enhancing students' environmental awareness and cultivating a sense of stewardship.

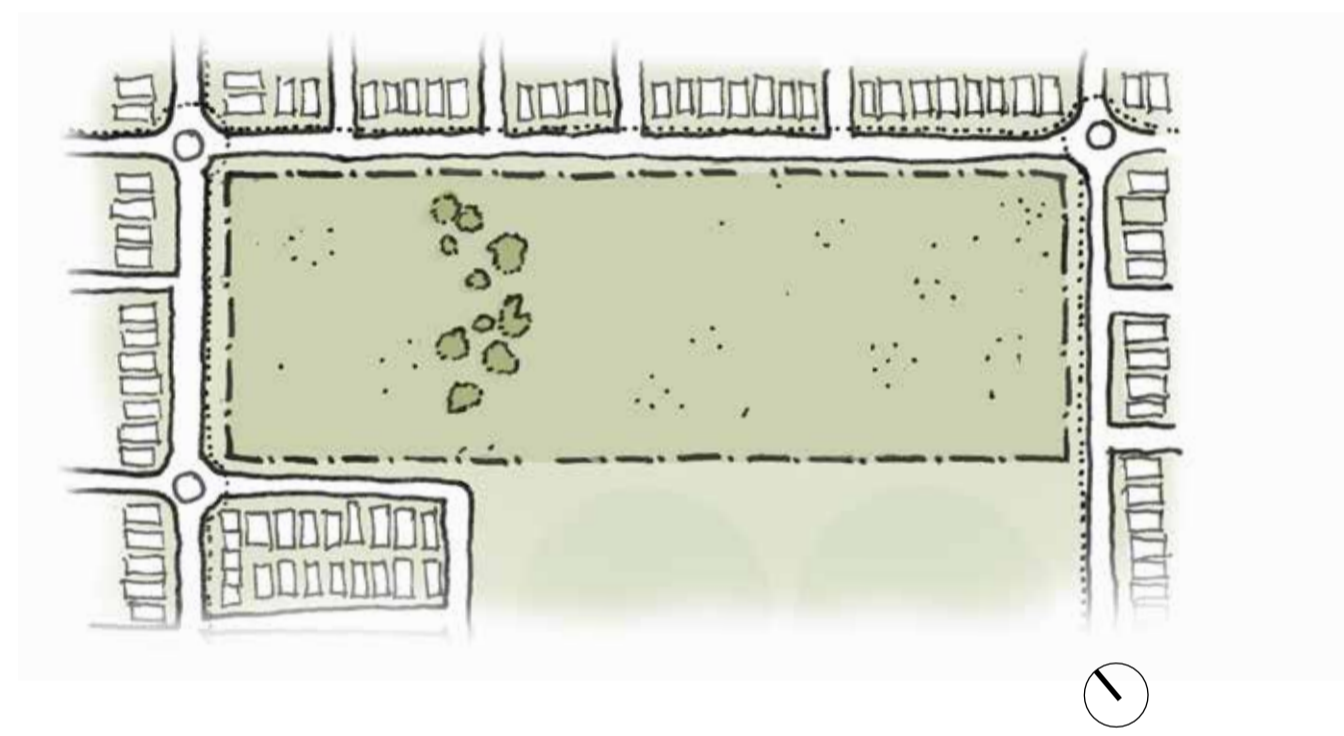

THE JOSEPHITES

The Josephite emblem, central to MacKillop College's Catholic identity, inspires the Master Plan layout.

The emblem celebrates the College's commitment to a warm and welcoming environment which strives to encourage creative courage, mutual respect, conscious compassion and intentional inclusivity.

The geometric form overlaid on the site provides the basic structure of the Master Plan and defines zones of use for the sub-schools, play spaces and outdoor learning areas.

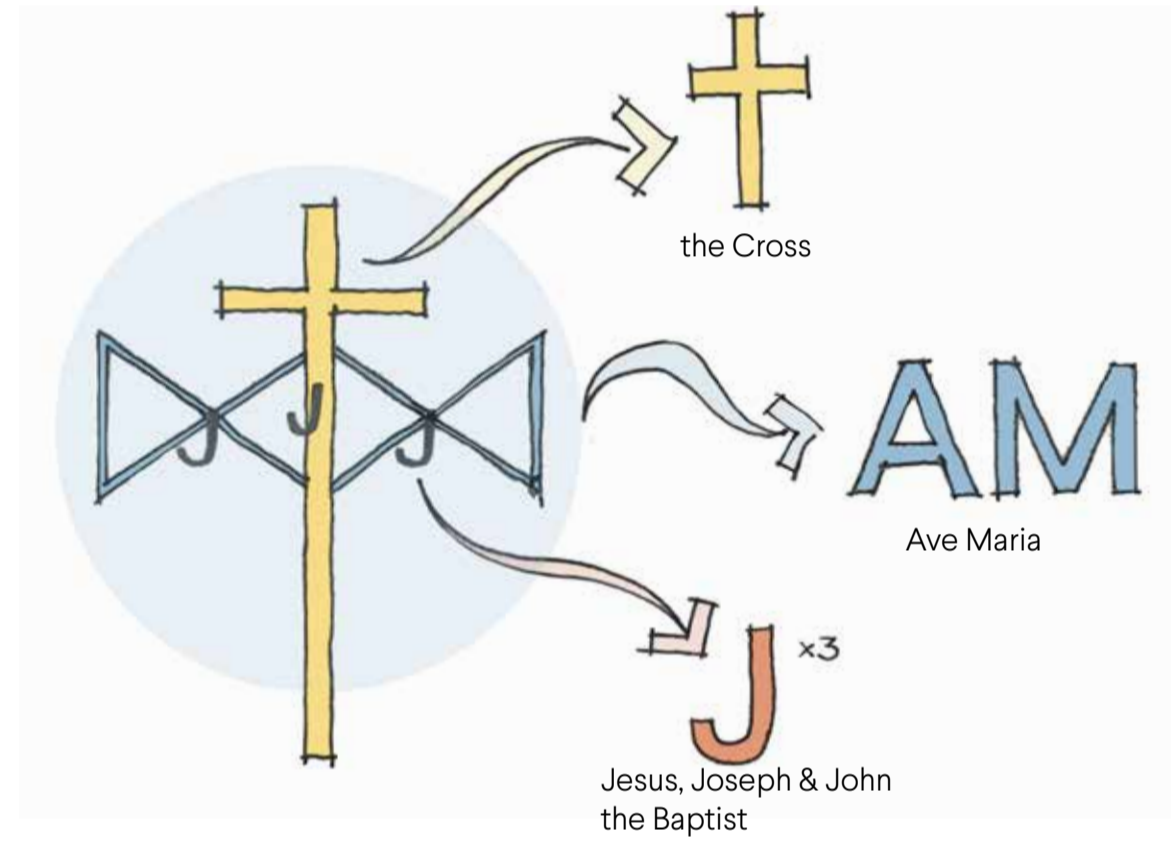

MASTER PLAN CONCEPT

The Josephite pathways form the central concept at the heart of the master plan. The pathways provide a simple plan form around which the new facilities are planned. References to Josephite values will be located at the intersections of the pathway.

This design reinforces the emblem's symbolic meaning, guiding movement through key areas and fostering connection, accessibility and a sense of belonging, reflecting Josephite values.

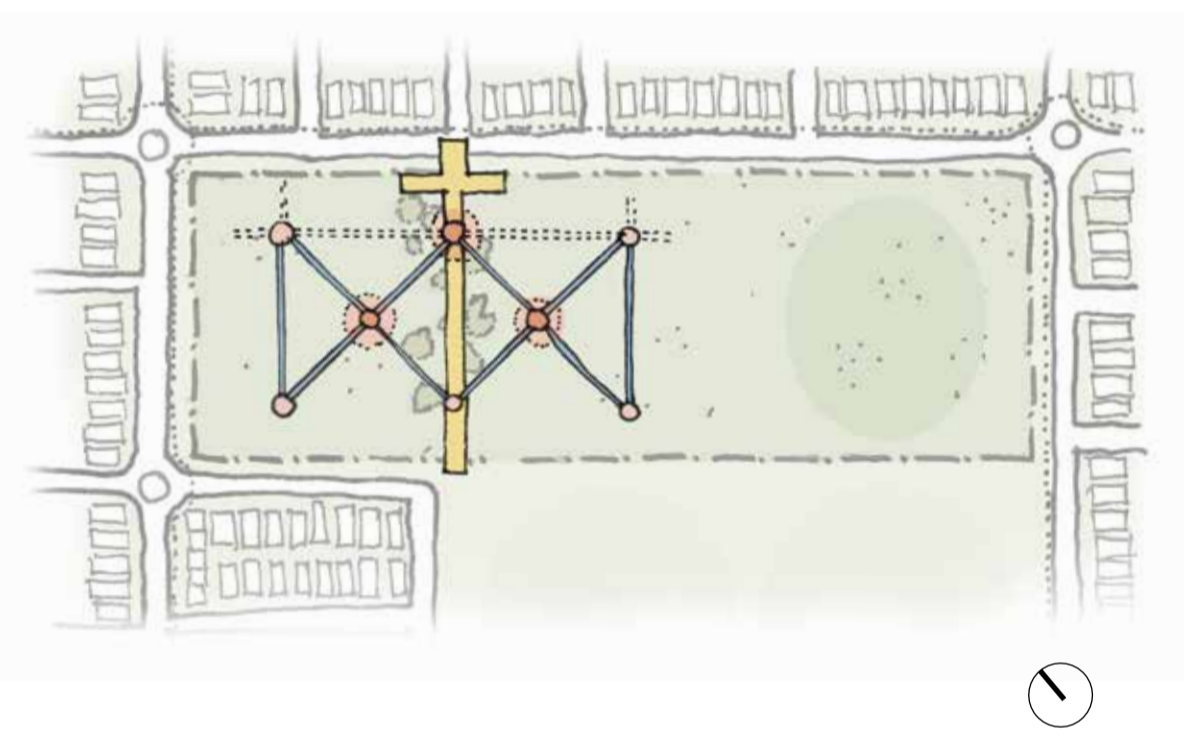

TREE OF LIFE

The Tree of Life marks the entrance to the new school campus, clearly demarcating the school entrance and creating connection with the identity of the other two campuses.

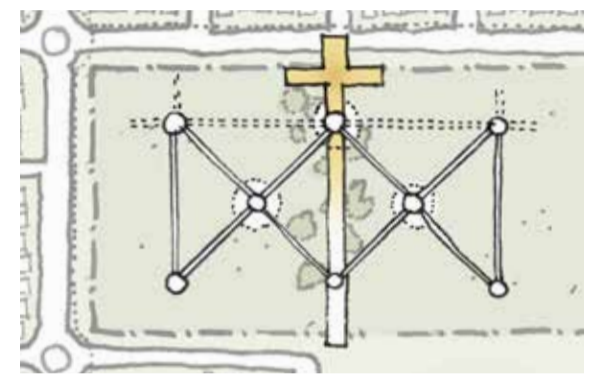

NODES

Sculptures of prominent Josephite figures positioned at key nodes, where pathways intersect, referencing the three J's of the Josephite Emblem.

Guidance will be sought from the school as to which figures should be included.

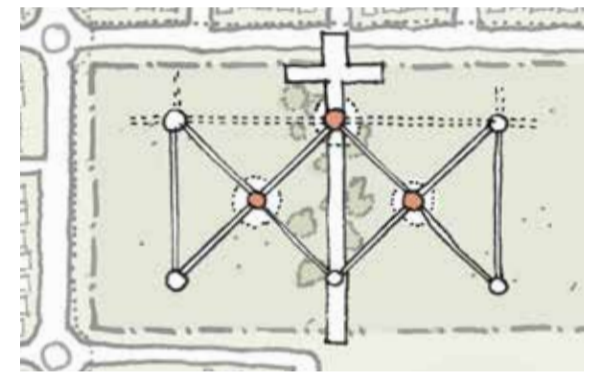

PEDESTRIAN PATHWAYS

Pedestrian pathways follow the A & M of Ave Maria, forming the basis of the circulation routes for the master plan solution.

The concrete will be inscribed with scripture along the route, a physical reference to the Catholic faith journey.

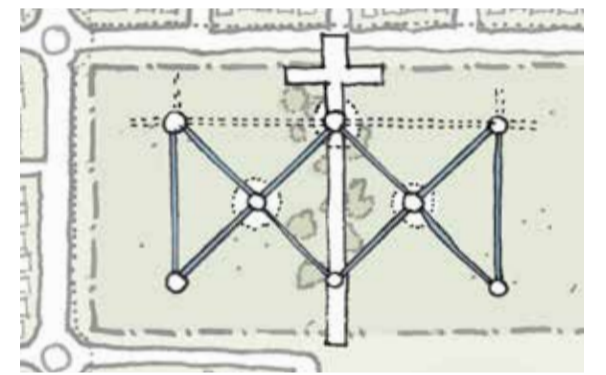

FORM

Simplicity in architectural form reflects the Josephites humble values by prioritizing essential needs over ornate features and people over possessions, creating a sense of belonging fostering community and connection.

Simple architecture is easier to construct, allowing for quicker builds and lower costs, making quality spaces accessible to more people.



MATERIAL

The use of sturdy natural looking materials harmonises with the environment promoting sustainability. These robust materials ensure longevity and stability, while a calm natural color palette with a focus on the School's colours creates a harmonious relationship between the built environment and nature.

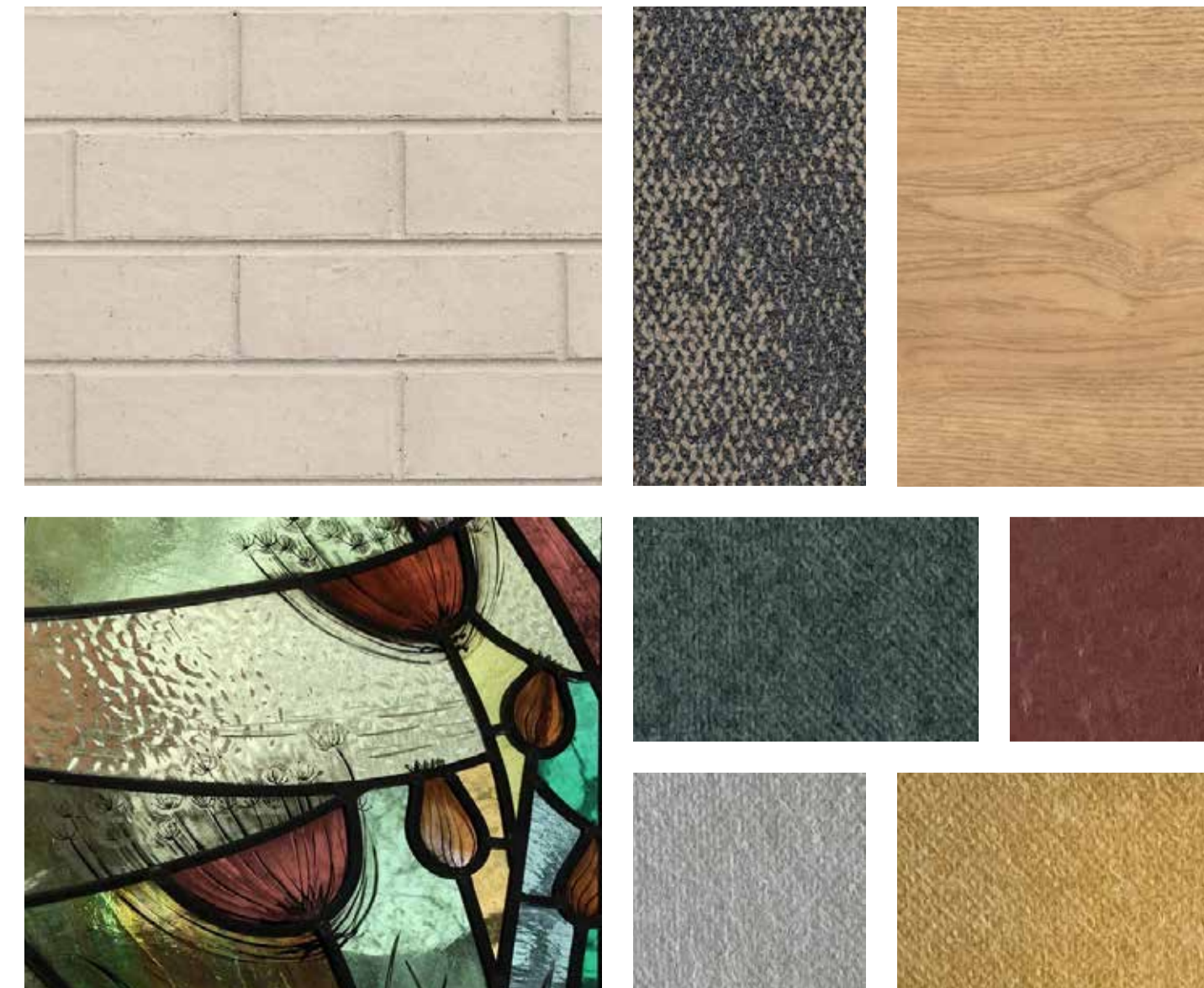

LIGHT

Thoughtful use of light creates uplifting, reflective spaces that foster a sense of peace. Natural light enhances mood, promoting warmth and openness while inviting contemplation.

Strategically placed windows and light-enhancing materials that interplay with light and shade can encourage introspection and personal growth.

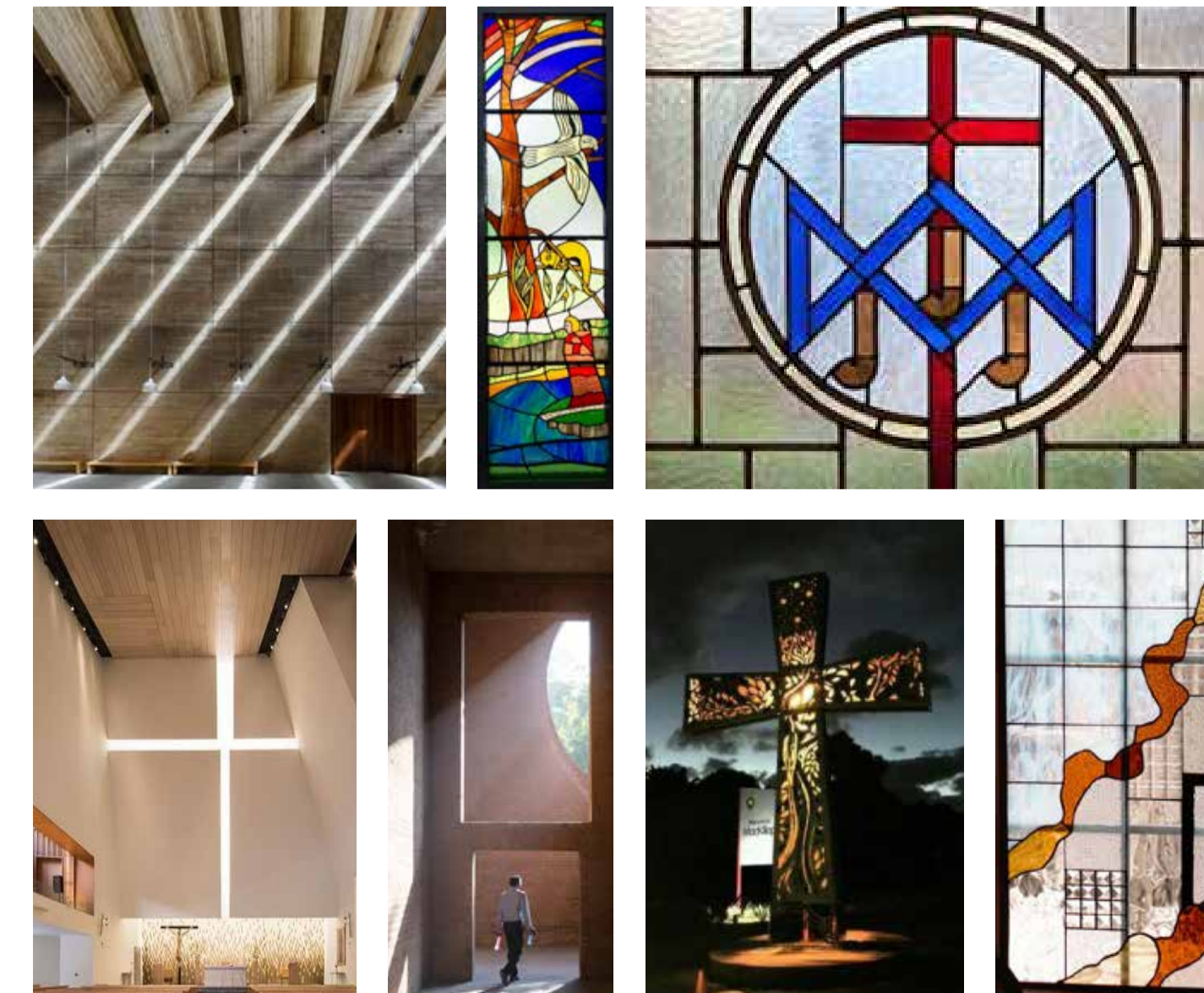

ENVIRONMENT

Integrating trees, water elements and local fauna into a landscape-led solution enhances ecological health and promotes well-being. These designs support biodiversity and foster a strong connection with nature, enriching the experiences of both students and staff.

By prioritizing nature in the design, we nurture healthier, more connected students who thrive in harmony with the natural world and contribute to the resilience of the school community and its ecosystem.



3 MASTER PLAN

MacKillop College | Wyndham Vale Campus



ACCESS & ENTRY

The Wyndham Vale Campus has been planned to take advantage of its three streetscapes.

The Main School Entry is located on Stanmore Crescent with Primary School facilities to the west and Secondary School facilities to the south.

The ELC is located to the western corner of the site, providing a separate space integrated into the Master Plan.

E EARLY LEARNING CENTRE & OUTSIDE SCHOOL HOURS CARE

The ELC and OHSC facilities are accessed via a vehicular and pedestrian entrance to the western corner of the site off Smile Crescent.

- E1 22 Car Parking Spaces
Service Vehicle Access
Pedestrian Entry adjacent

P PRIMARY SCHOOL

There are three separate Primary The visitor entry to the Primary School is at the centre of Stanmore Crescent with Reception located to the north of the Entry Courtyard.

The Primary School has been planned to address two street frontages. This should assist peak traffic flows at drop off and pick-up times

- P1 Pedestrian Entry Point 1
60 Car Parking Spaces
- P2 Pedestrian Entry Point 2
Vehicular Entry for
Emergency Vehicles &
Relocatable Delivery
- P3 Pedestrian Entry Point 3

S SECONDARY SCHOOL

The visitor entry to the Secondary School is at the centre of Stanmore Crescent with Reception located to the south of the Entry Courtyard.

An access road linking S2 and S3 allows access for emergency and maintenance vehicles.

Car parking can be accessed from each of the street frontages, to assist with peak traffic flows.

- S1 Pedestrian Entry Point 1
100 Car Parking Spaces
- S2 Pedestrian Entry Point 2
Vehicular Entry for
Relocatable Delivery
- S3 Pedestrian Entry Point 3
Access For Maintenance
& Emergency Vehicles
90 Car Parking Spaces
- S4 Pedestrian Entry Point 4
Service Vehicle Access
- S5 100 Car Parking Spaces
Link to Access Road

C COMMUNITY

The Main Entry to the school is on Stanmore Crescent at the centre of the site. This provides the public with access to the Chapel, Primary and Secondary Reception areas and also after hours access to the Secondary Resource Centre.

The Environmental Avenue separates the Primary and Secondary School facilities, leading to another community entrance to the south of the site. This entrance links the community playing fields and shared use car park to the school site via Smile Crescent

- C1 Main School Entrance
Entrance to Chapel
Pedestrian Entry Point 1
- C2 Pedestrian Entry Point 2
Community Car Park
100 Car Parking Spaces
(Shared Use)
- C3 Pedestrian Entry Point 3
Access to Sporting Facilities

4 DELIVERY

MacKillop College | Wyndham Vale Campus

ELC - 2027

- Reception & Offices
- 3 Room Kindergarten
- Kitchen, Laundry
- OSHC & Community Spaces
- Toilets & Stores
- Outdoor Playspace
- ELC Car Park - 22 spaces

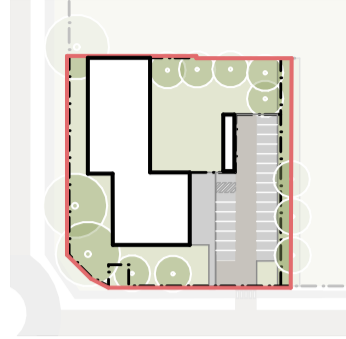
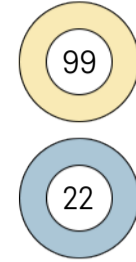

STAGE 1 - 2028

- A ADMINISTRATION**
Primary & Secondary (Combined)
Wellness & Support (Combined)
Primary School Car Park - 60 spaces
- JUNIOR PRIMARY LEARNING CENTRE**
9 Classrooms
STEAM - Art & Craft
Toilets
Staff Planning and Resource spaces
- HARD COURT (COVERED)**
- B MUSIC, MEDIA, DANCE & DRAMA**
Music Practice & Performance spaces
Black Box Theatre
Staff Planning and Office spaces
- HOSPITALITY**
2 Food Technology Kitchens
1 Commercial Hospitality Kitchen
Barista Cafe
Temporary Canteen
- C YEAR 7 & 8 LEARNING CENTRE**
2 Storey Learning Centre
16 Classrooms
2 Junior Secondary Science Wet Labs
Student Hub & Locker Area
Staff Planning and Office spaces
Toilets & Lift

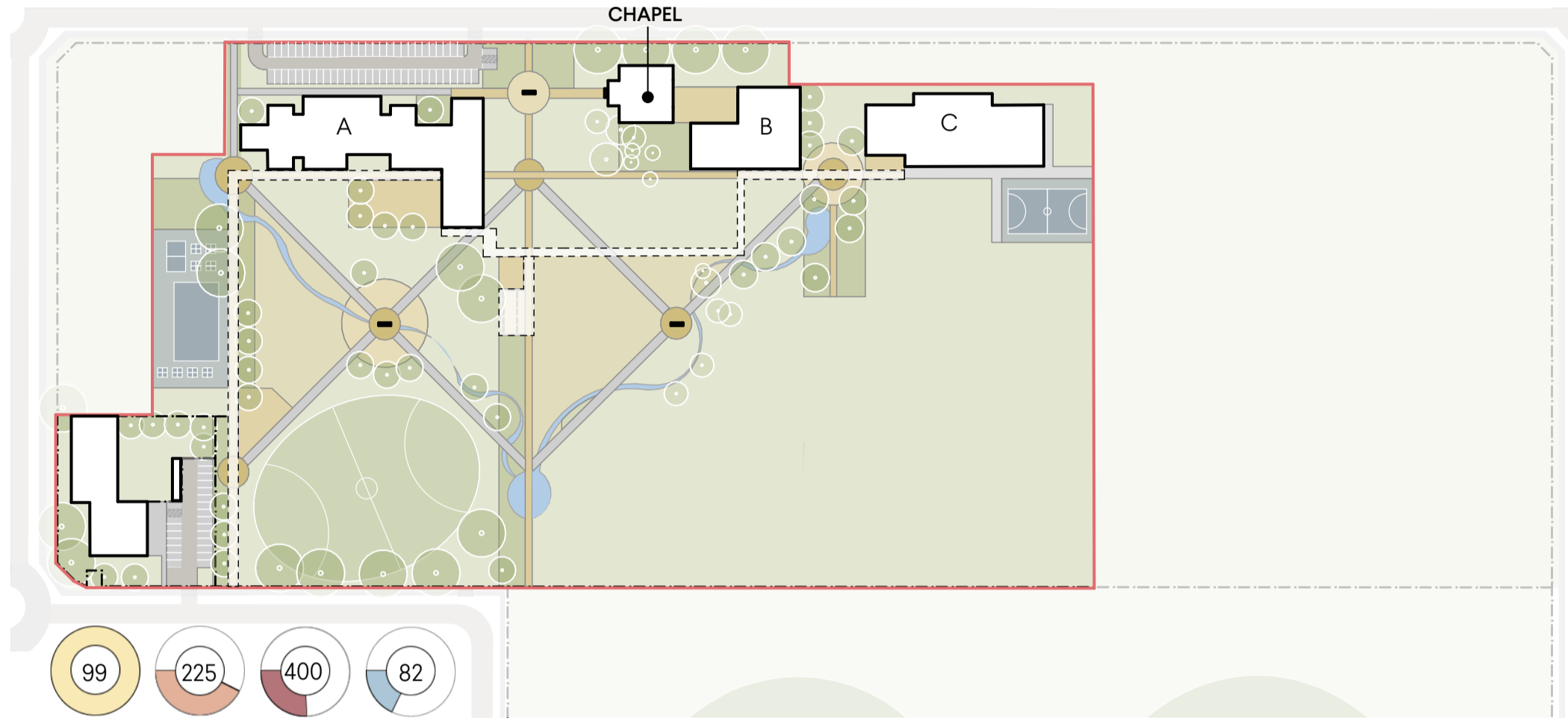

STAGE 4

- L GYMNASIUM**
Two Court Indoor Competition
Sized Gymnasium
PE & Health Classroom
Staff Planning and Office spaces
Change Rooms
Foyer
Weights Room
Community Rooms
Maintenance Sheds
Secondary School Oval
Running Track
Soccer Pitch
Bus Parking
Secondary Car Park - 120 spaces

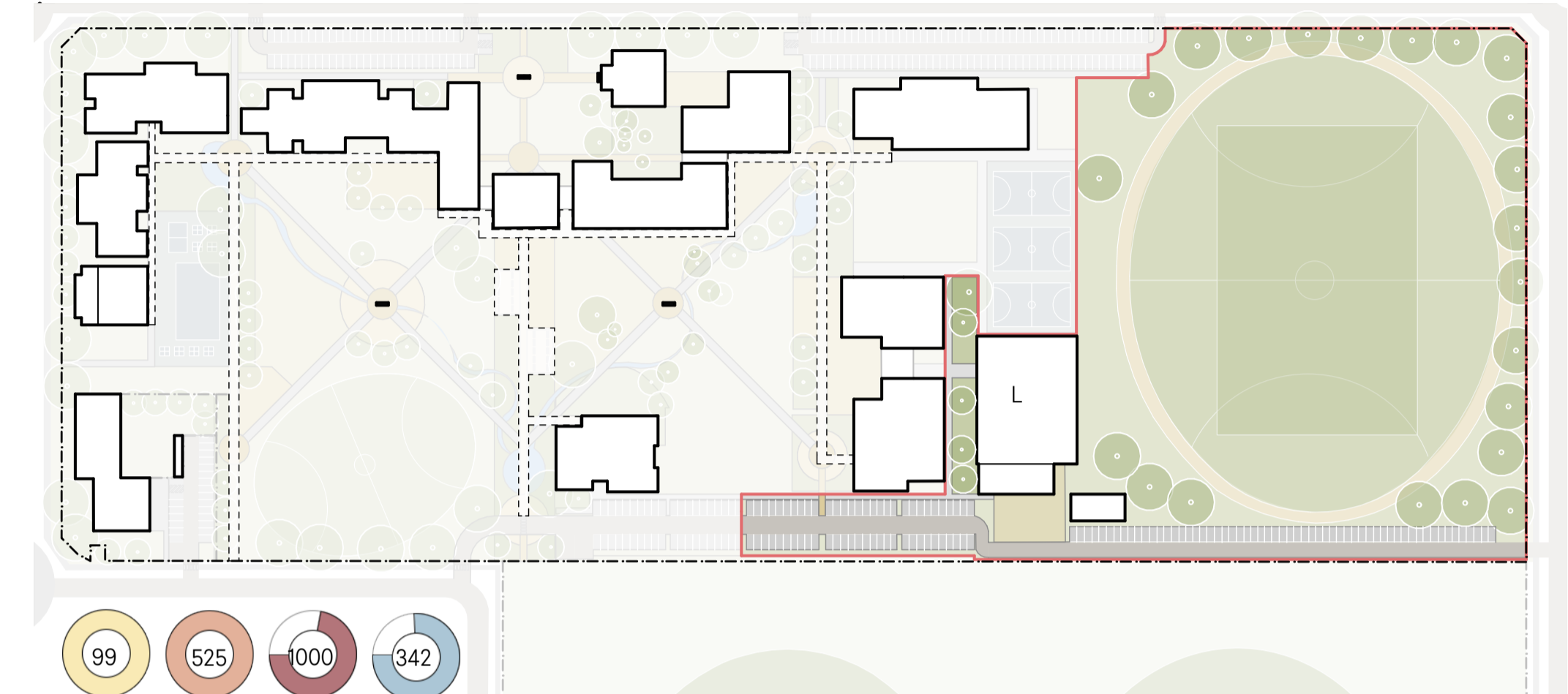

STAGE % COMPLETE

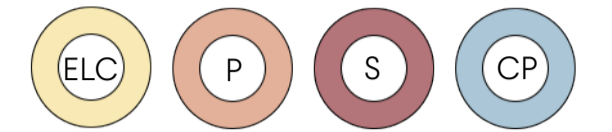

ELC, Primary, Secondary Student and Car Park numbers at the completion of each stage

STAGE 2

- D SENIOR PRIMARY LEARNING CENTRE**
6 Classrooms
STEAM - Science
Toilets
Staff Planning and Resource spaces
- E PRIMARY HALL**
Multi-Purpose Hall with Stage
Music/Drama
Toilets
Canteen & Stores
- F SECONDARY SPECIALIST SPACES**
2 Storey STEAM Centre
6 Science Labs
3 Digital Technology Spaces
3 Art & Design Spaces
(to be converted to Science in Stage 5)
Staff Planning and Office spaces
- G YEAR 9 & 10 LEARNING CENTRE**
2 Storey Learning Centre
12 Classrooms
Student Hub & Locker Area
Staff Planning and Office spaces
Toilets
Lift
Secondary Car Park - 100 spaces
- 2 or 3 HARD COURTS (TBC)**

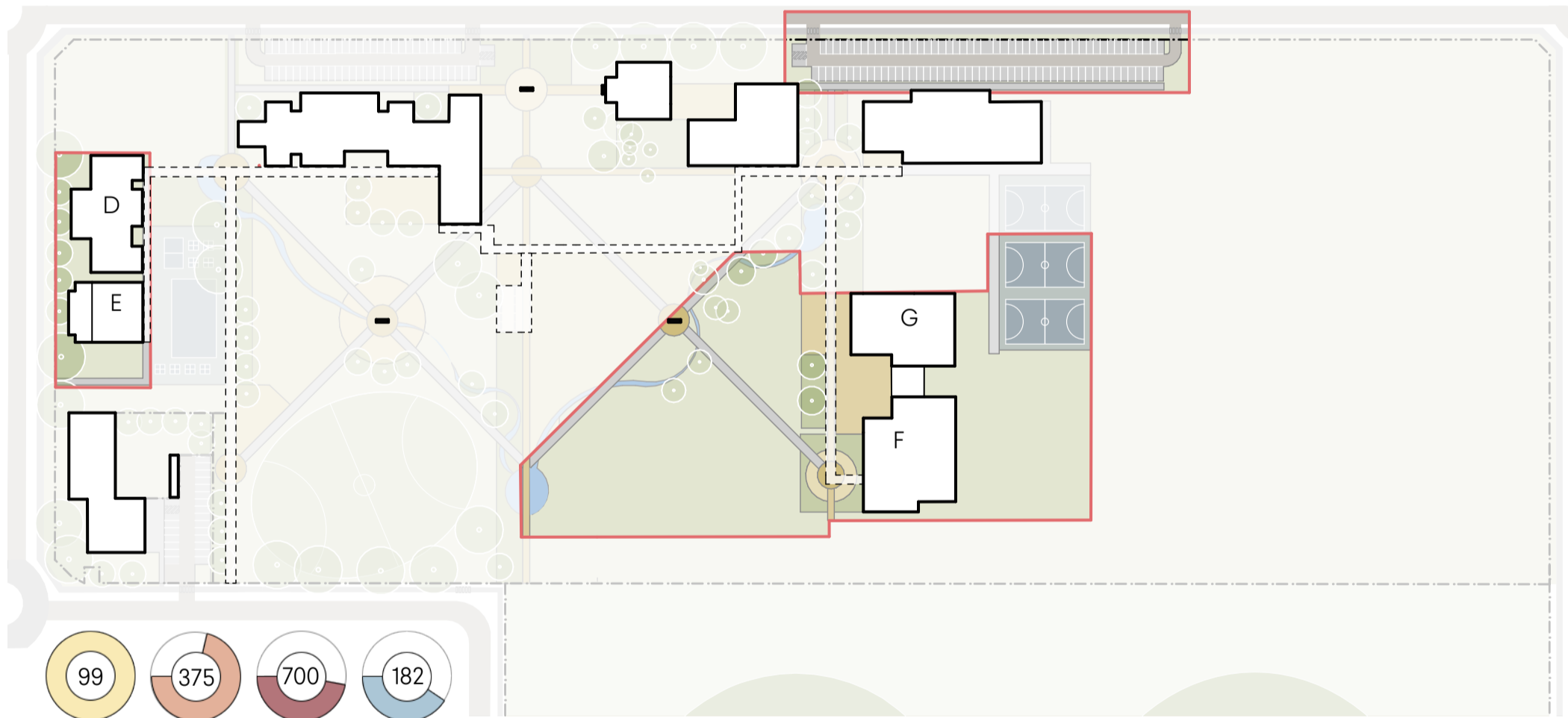

STAGE 5

- M SECONDARY SPECIALIST SPACES**
2 Storey STEAM Centre
6 Art Studios
6 Design Technology Spaces
Staff Planning and Office spaces
Toilets

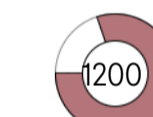

STAGE 6

- N YEAR 9 & 10 LEARNING CENTRE**
2 Storey Learning Centre
12 Classrooms
Student Hub & Locker Area
Staff Planning and Office spaces
Toilets
Joint Venture Shared Use
Community Car Park - 100 spaces

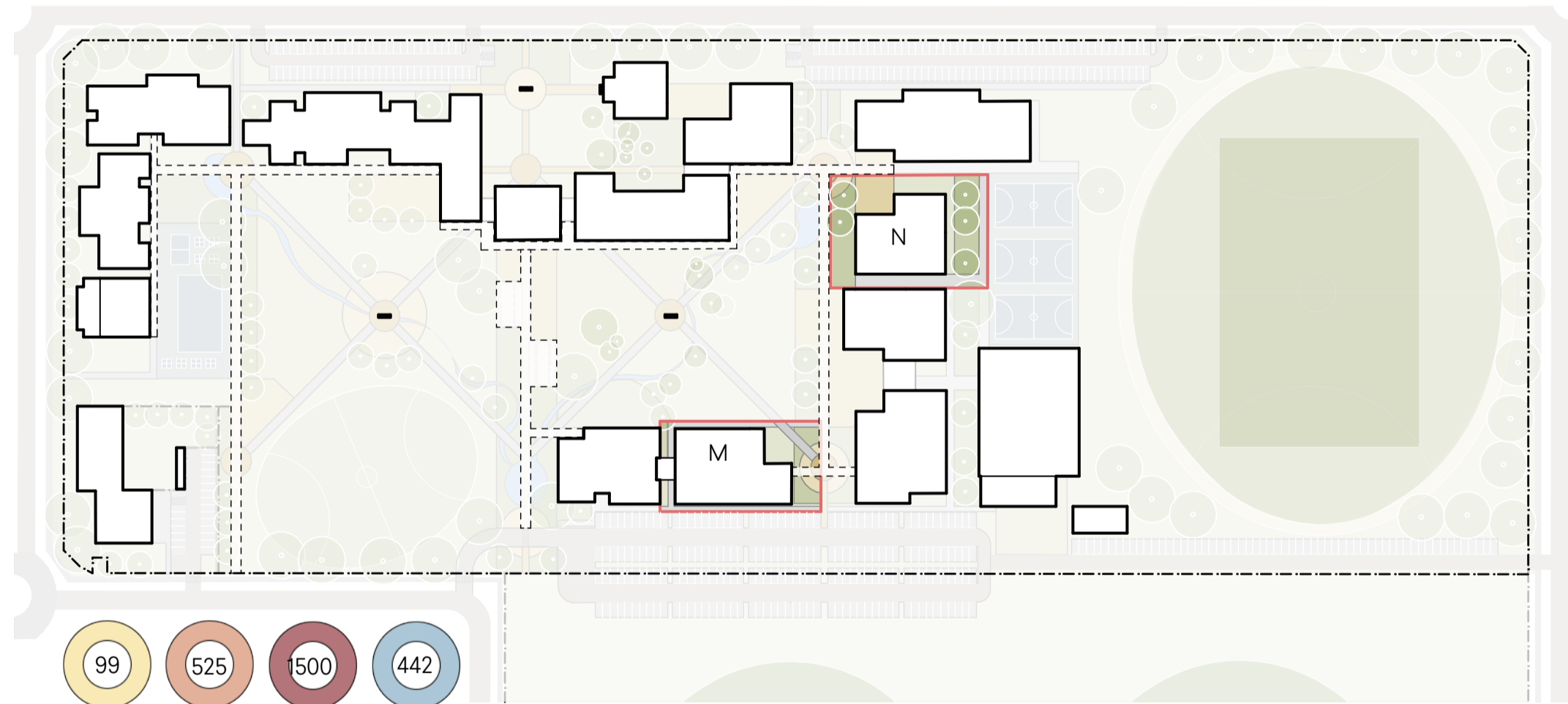

STAGE 3

- H MIDDLE PRIMARY LEARNING CENTRE**
6 Classrooms
STEAM - Food Technology
Library Resource Centre
Toilets
Staff Planning and Resource spaces
- I SECONDARY ADMINISTRATION**
Staff Planning
Offices
Staff Lounge & toilets
- J VCE LEARNING CENTRE**
2 Storey Learning Centre
12 Classrooms
Student Hub & Locker Area
Staff Planning and Office spaces
Toilets & Lift
Secondary Car Park - 40 spaces
- K SECONDARY RESOURCE CENTRE**
Staff and Student Planning Spaces
IT Hub
Library
Student & Staff Resources
Canteen

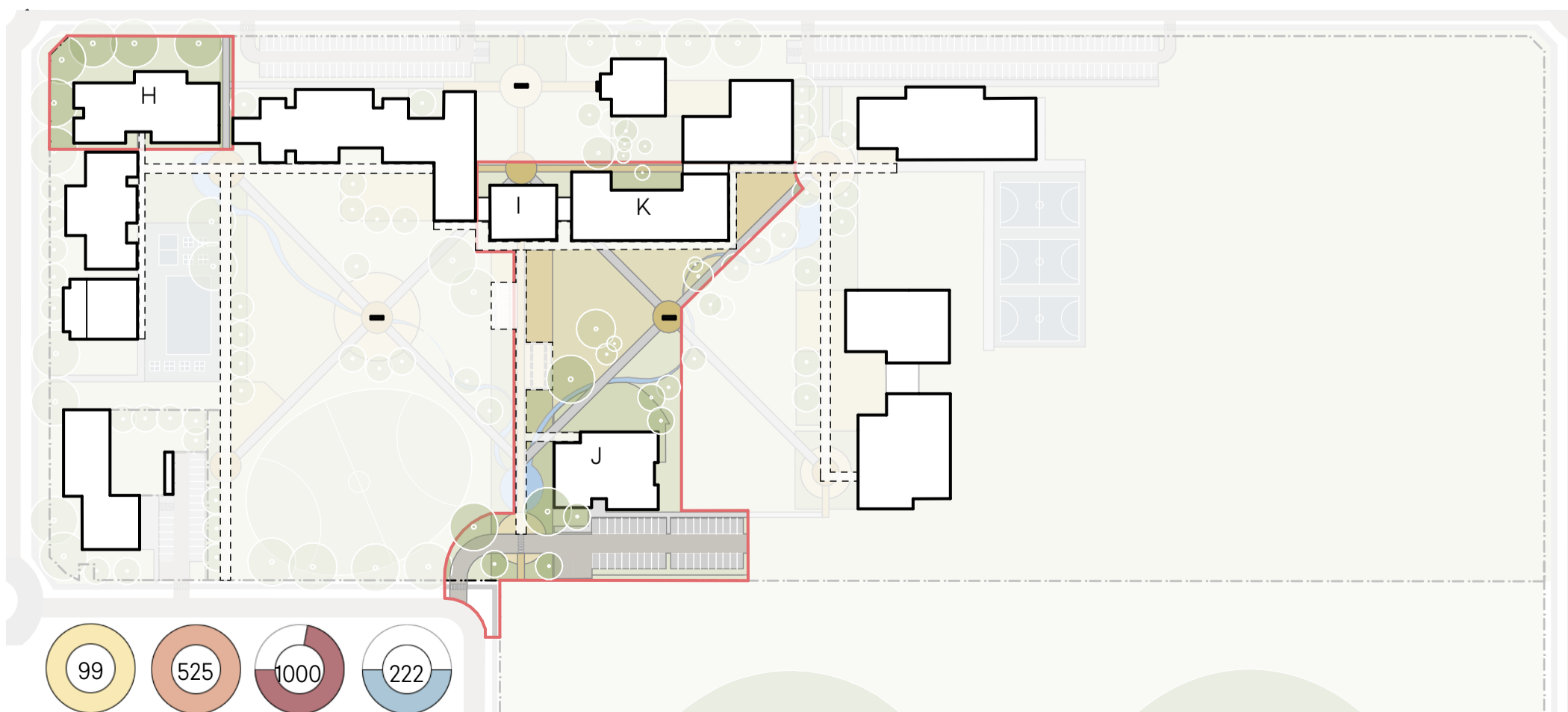

MASTER PLAN

- A PRIMARY ADMINISTRATION**
JUNIOR PRIMARY LEARNING CENTRE
- B HOSPITALITY & FOOD TECHNOLOGY**
MUSIC & DRAMA
- C YEAR 7 & 8 LEARNING CENTRE**
- D SENIOR PRIMARY LEARNING CENTRE**
- E PRIMARY HALL**
- F SECONDARY SPECIALIST SPACES**
- G YEAR 9 & 10 LEARNING CENTRE**
- H MIDDLE PRIMARY LEARNING CENTRE**
- I SECONDARY ADMINISTRATION**
- J VCE LEARNING CENTRE**
- K SECONDARY RESOURCE CENTRE**
- L GYMNASIUM**
- M SECONDARY SPECIALIST SPACES**
- N YEAR 9 & 10 LEARNING CENTRE**
- R RELOCATABLES**



5 ENTRY

MacKillop College | Wyndham Vale Campus

CHAPEL

The Chapel is located with a prominent street address, at the welcoming main entry forecourt to the school. Primary and secondary school reception areas are easily identifiable from the forecourt and are centered around the Tree of Life demonstrating the School's Catholic Identity.



PRAYER GARDEN

A Prayer Garden is located accessible from the entry forecourt. This tranquil space is adjacent to the chapel, offering opportunity for spiritual encounter, supporting the integration of faith and learning.



SECONDARY ADMIN & STAFF

The Secondary School reception area is accessed adjacent to, but separate from, the Primary School reception. The Staff Lounge is a space separate to the Staff Work Spaces for relaxation and networking. Connected to the Resource Centre with operable walls to accommodate large group activities.



WELLBEING CENTRE

A shared facility for both Primary and Secondary staff and students. The Wellbeing Centre includes office spaces for counselors, therapists, support staff and sick bay. A non-timetabled space for students to withdraw, regulate, relax and seek support.



PRIMARY ADMIN

To be shared by the Primary & Secondary Schools until Stage 3 when the separate Secondary Administration area is delivered.

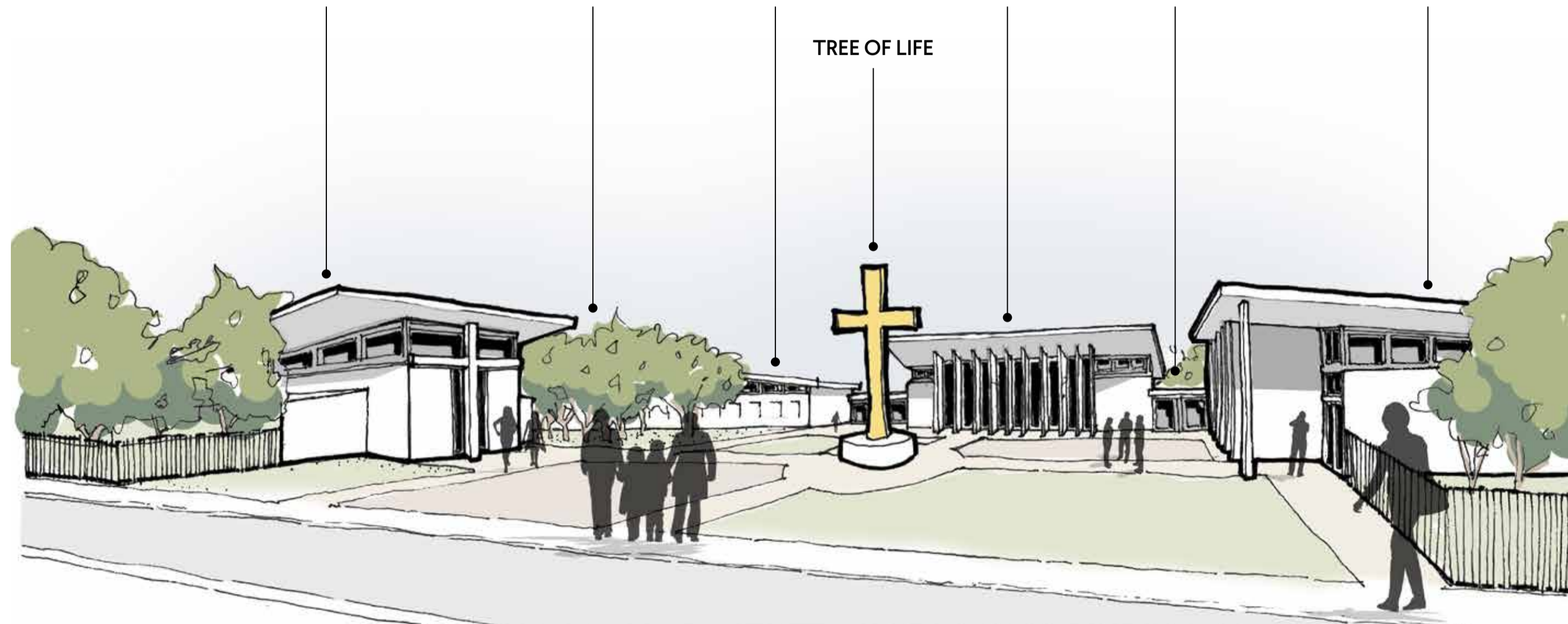

TREE OF LIFE



SOLAR POWERED BICYCLE SHEDS

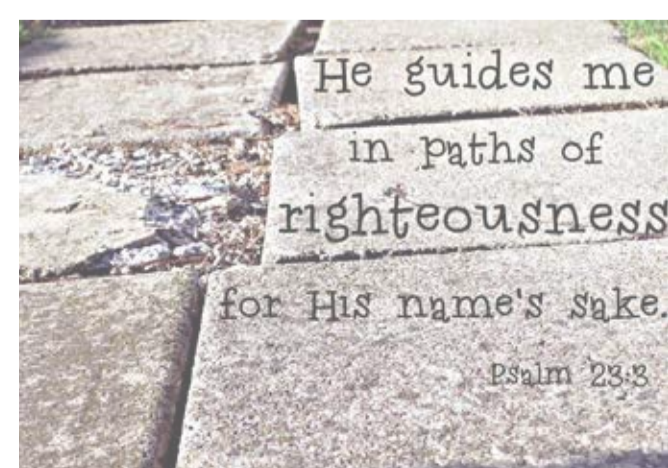

JOSEPHITE PATHWAYS



REFLECTION POND



COVERED WAYS

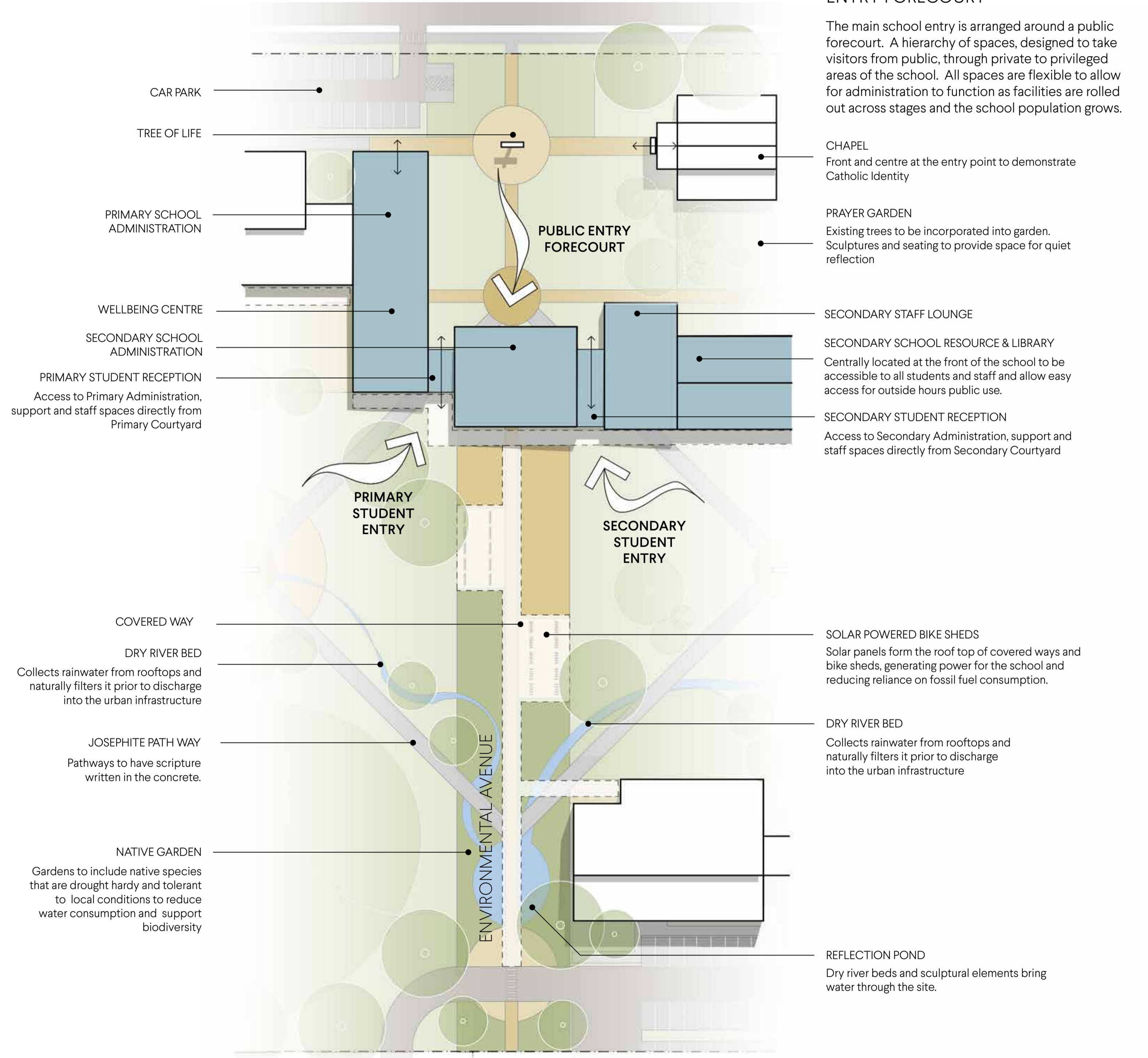

ENTRY FORECOURT

The main school entry is arranged around a public forecourt. A hierarchy of spaces, designed to take visitors from public, through private to privileged areas of the school. All spaces are flexible to allow for administration to function as facilities are rolled out across stages and the school population grows.

CHAPEL
Front and centre at the entry point to demonstrate Catholic Identity

PRAYER GARDEN
Existing trees to be incorporated into garden. Sculptures and seating to provide space for quiet reflection

SECONDARY STAFF LOUNGE

SECONDARY SCHOOL RESOURCE & LIBRARY
Centrally located at the front of the school to be accessible to all students and staff and allow easy access for outside hours public use.

SECONDARY STUDENT RECEPTION
Access to Secondary Administration, support and staff spaces directly from Secondary Courtyard

SOLAR POWERED BIKE SHEDS
Solar panels form the roof top of covered ways and bike sheds, generating power for the school and reducing reliance on fossil fuel consumption.

DRY RIVER BED
Collects rainwater from rooftops and naturally filters it prior to discharge into the urban infrastructure

REFLECTION POND
Dry river beds and sculptural elements bring water through the site.

ENVIRONMENTAL AVENUE

Pope Francis' 2015 encyclical underscores the moral imperative for urgent action on climate change. The central axis created by the Josephite Pathways, defines the primary and secondary school zones with an avenue dedicated to the environment.

It demonstrates to the school community how the environment should be respected, cultivated and celebrated.

WATER

Rainwater is harvested from the covered way rooftops and fed into a dry river bed. This filters the storm water prior to it being discharged into the street infrastructure.

Water travels through the site to a reflection pond at the end of the avenue. This is a quiet contemplative space with a sculpture at its centre.

Excess rainwater is harvested to provide irrigation to the ovals and garden beds, and water for flushing toilets.

SHELTER

The avenue provides shelter from the rain and sun via covered ways. These provide spaces for passive recreation and gathering.

Corridors of planting across the site allow space for large trees to mature. These will provide natural shelter from the sun during the hot summer months, and habitat for bird life, native animals and insects

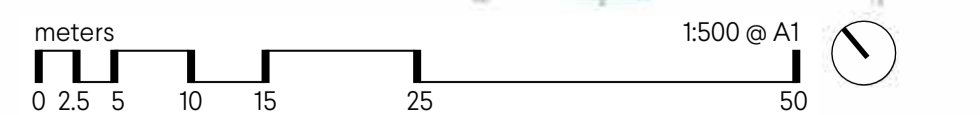

6 LEARNING

MacKillop College | Wyndham Vale Campus

PRINCIPLES OF DESIGN

All spaces to be designed for maximum flexibility to allow for curriculum to be delivered as facilities are rolled out across stages. Primary learning spaces are single storey facilities of domestic scale in sympathy with the surrounding residential development. This is the most economical building typology and allows for excellent access to outdoor learning environment directly from indoor teaching spaces. Secondary facilities are two storey, to ensure that adequate open space is available. The vertical spaces provide opportunity for cohort hub spaces and linking support spaces.

All teaching and learning spaces have good access to fresh air and be well insulated to reduce reliance on air conditioning.
 Cross flow ventilation and natural light to be maximized through well considered orientation of buildings.
 Deep eaves and covered walkways to provide shade and shelter.

Learning spaces are flexible. They can open on to each other allowing for collaborative pedagogy, or close down to a traditional classroom setting.
 Each cohort is arranged around a central break out space adjacent to a STEAM Space.

Buildings are oriented to minimize heat gain and maximize access to light and cross flow air.
 Natural light is celebrated, reducing reliance on artificial lighting.

Each learning centre has teaching spaces arranged around a tiered hub. This area allows for whole group assembly, presentations and collaborative activities.

Travel areas are wide allowing for ease of movement. Lockers are contained within the Learning Centre for convenience.

Staff spaces are located in each learning centre in key learning area groupings.

Design to be simple and modular to ensure economies of scale. Consistent systems to be employed to ensure ease of transition between campuses and to reduce costs associated with maintenance contracts. Lessons learned from existing facilities to inform the design of the new campus

Multi-level buildings to be linked with vertical transport, amenity and staff spaces in the shared areas. This will reduce the number of lifts required on site, reducing cost and providing equitable access for all.

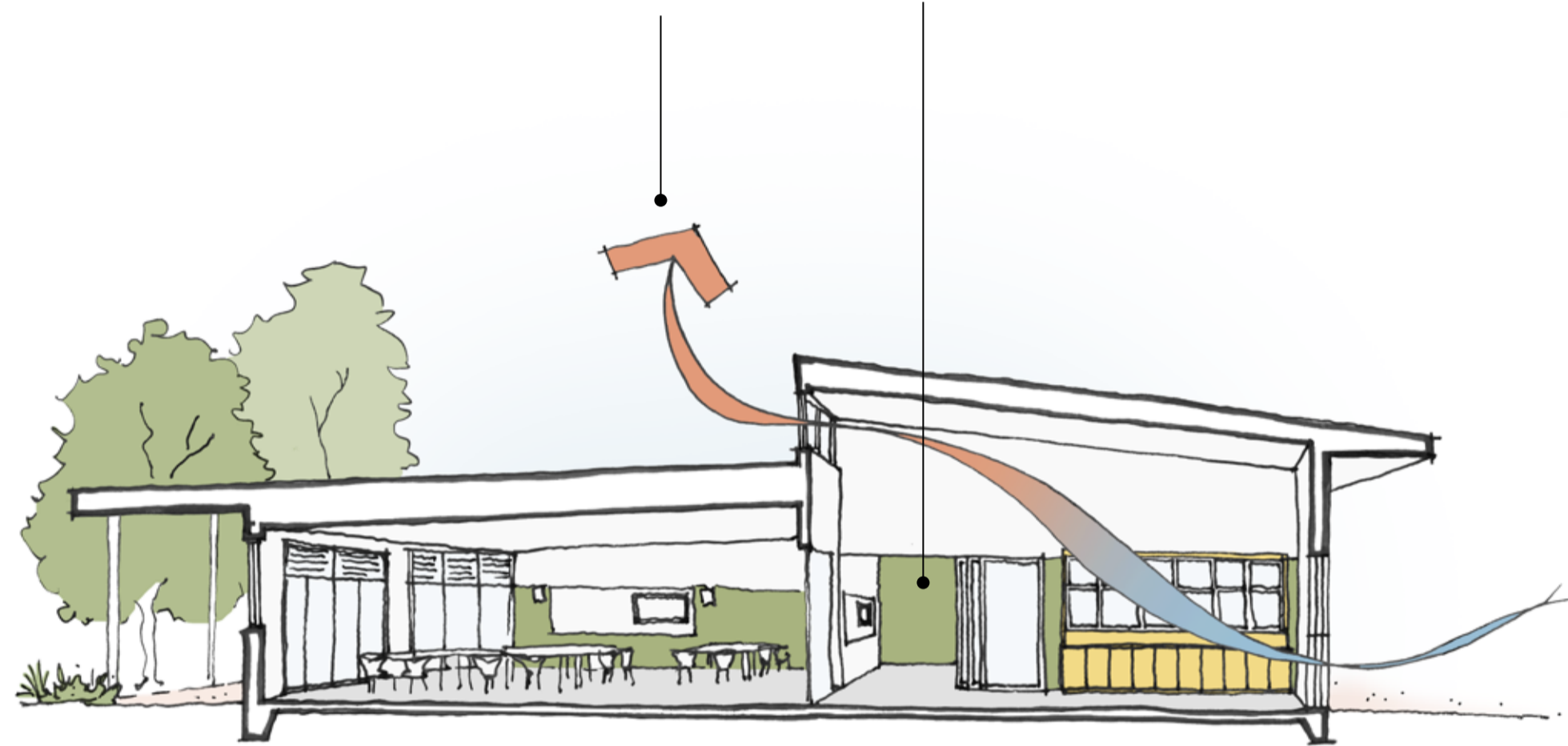

PRIMARY LEARNING CENTRE SECTION

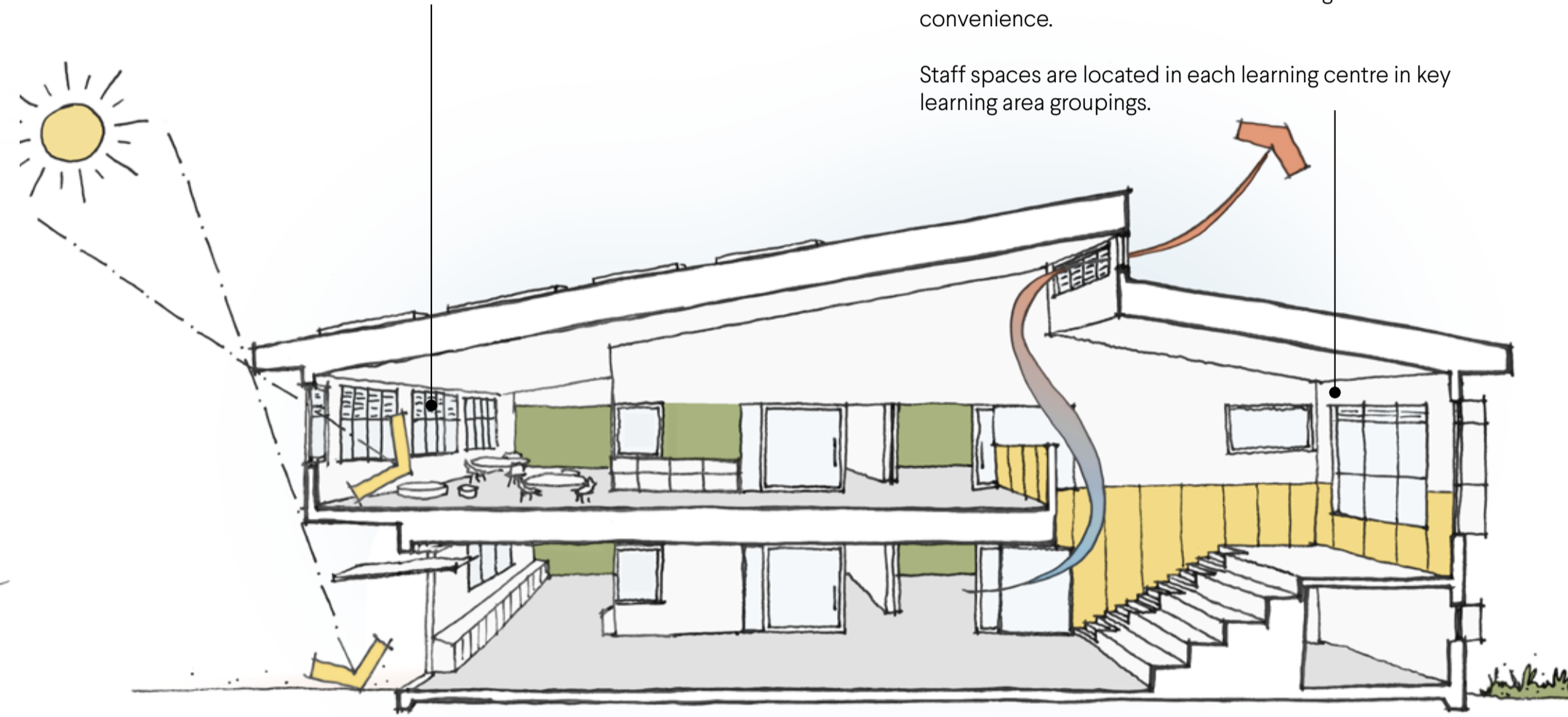

SECONDARY LEARNING CENTRE SECTION



VALUE ADDING

PRIMARY SCHOOL



MIDDLE PRIMARY LEARNING CENTRE

6 Flexible, connected teaching spaces that allow for class privacy and collaboration.
 STEAM - Food Technology
 Library Resource Centre
 Student Toilets & Staff Spaces

JUNIOR PRIMARY LEARNING CENTRE

9 Flexible, connected teaching spaces that allow for class privacy and collaboration
 STEAM - Art & Craft
 Student Toilets & Staff Spaces

SENIOR PRIMARY LEARNING CENTRE

6 Flexible, connected teaching spaces that allow for class privacy and collaboration
 STEAM - Science
 Student Toilets & Staff Spaces

PRIMARY HALL

Multi-Purpose Hall opening out to covered hard court area for large gatherings
 Music/Drama teaching space
 Toilets, Canteen & Store

PRIMARY RELOCATABLES

7 Single storey modular classrooms

ELC

Reception & Offices
 3 Room Early Learning Centre
 Kitchen, Laundry, Toilets & Stores
 Outdoor Playspace
 22 Car Parking Spaces

OSHC

Large Space adjacent to kitchen facilities and toilets for use by OSHC and community groups

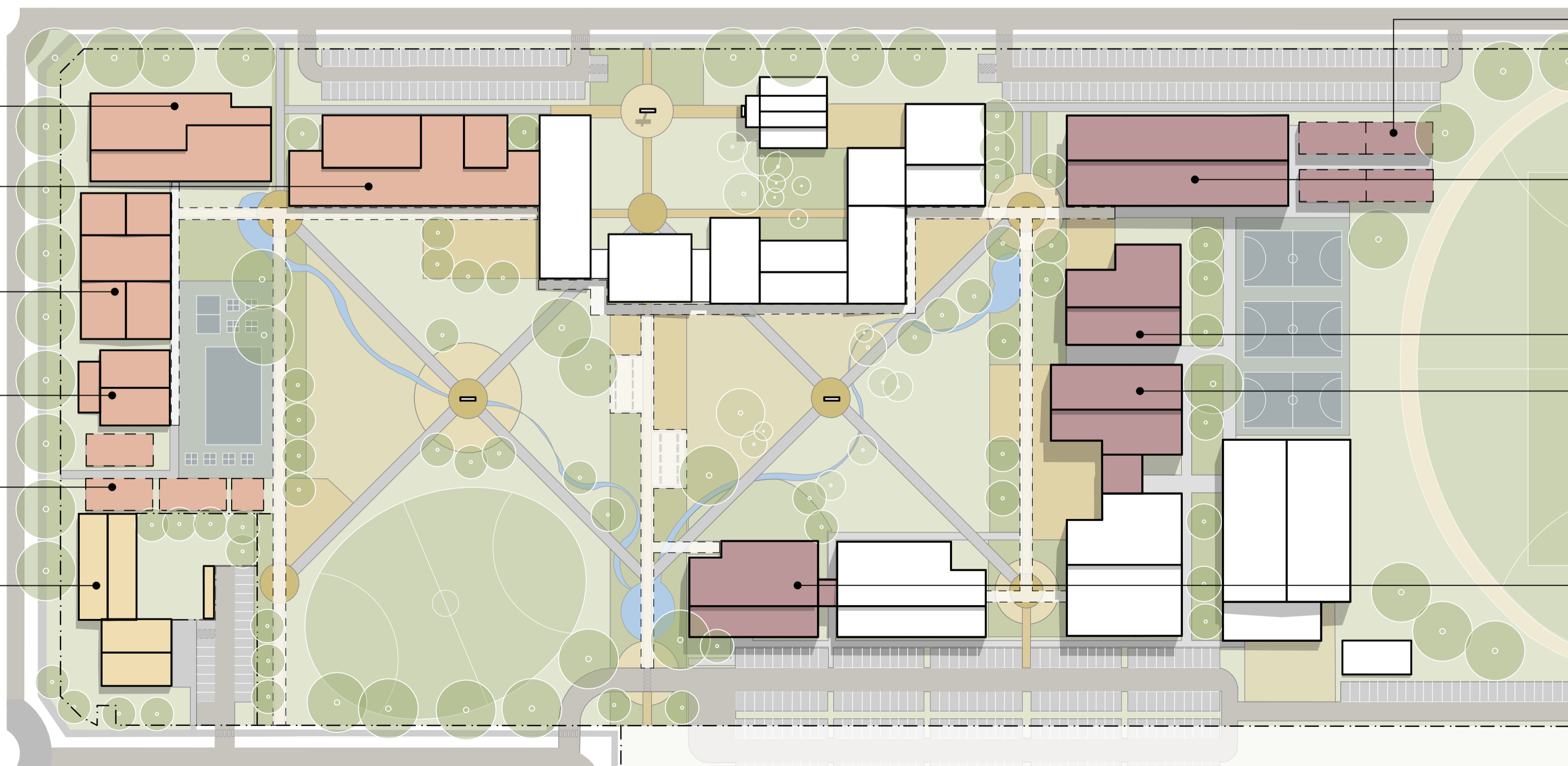

SECONDARY SCHOOL

SECONDARY RELOCATABLES

16 Double storey modular classrooms

YEAR 7 & 8 LEARNING CENTRE

2 Storey Learning Centre with 16 flexible teaching spaces that can open into shared collaborative spaces or be closed for traditional class group activities.
 Junior Secondary Wet Lab at each level, to enable Science to be offered prior to the development of the Secondary STEAM spaces in later stages.
 Staff Planning & Office spaces
 Student Hub/Locker Area & Toilets

YEAR 9 & 10 LEARNING CENTRES

Two x 2 Storey Learning Centres - 12 flexible teaching spaces in each, that open into shared collaborative space. All spaces can be closed for traditional class group activities.
 Learning centres to be delivered in separate stages as school population grows.
 Staff Planning & Office spaces
 Student Hub/Locker Area & Toilets

VCE LEARNING CENTRE

2 Storey Learning Centre - 12 traditional teaching spaces that allow for focused learning. Flexibility through variety and size of spaces to cater to small, medium and standard classes.
 Small group areas for break out, private study, student and staff meetings.
 VCE Staff Planning and Office Spaces
 Student Hub/Locker Area & Toilets

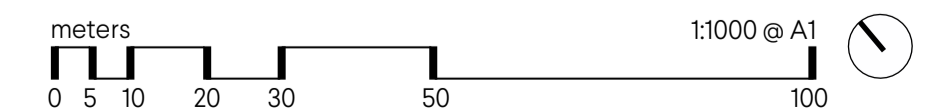
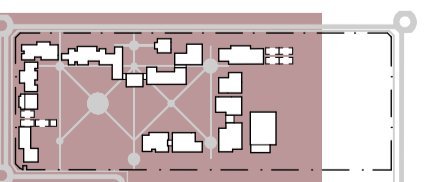

7 SPECIALISTS

MacKillop College | Wyndham Vale Campus

PERFORMING ARTS

Located at main street frontage to allow for public access.
 Black Box Theatre
 Music room
 Practice rooms
 Media room
 Staff Planning and Office space



HOSPITALITY & FOOD TECHNOLOGY

2 Food Technology Kitchens
 1 Commercial Hospitality Kitchen
 Barista Cafe
 Canteen

Hospitality & Food Tech spaces are located linking community use facilities along the main street frontage. These spaces can support events in the Black Box Theatre and Chapel.

A Barista training cafe and canteen are located adjacent to the food courtyard. This space will provide informal connections for students and staff in a relaxed environment.

FOOD COURT YARD



MEDIA



CAFE



CANTEEN



FOOD TECH



HOSPITALITY



SPORT & RECREATION

2 Court Competition Basketball and Netball Stadium with associated change and support spaces.

Secondary College Oval to be located adjacent to Community Ovals to the south of the site, creating sporting precinct for broader community use.

Stadium to be offered for community use reinforcing community connections.

Shared use car park to be developed to south of site reducing area required on school site for car parking.



INDOOR COURTS

PHYSICAL EDUCATION

Three hard courts for Basketball and Netball
 AFL sized oval
 Running track
 Soccer pitch

STADIUM

Two Court Indoor Competition Sized Gymnasium
 Indoor Netball, Basketball and Volleyball Courts
 Change Rooms & Toilets
 Foyer accessible to the community outside school hours
 Weights Room and Gym
 PE and Health teaching space.
 Staff Planning and Office Spaces
 Community Rooms

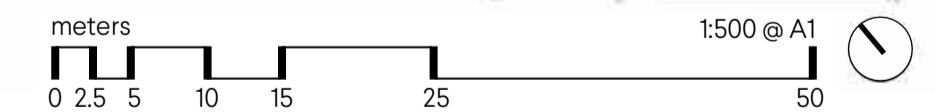

STEAM

DIRTY
 2 Storey STEAM Centre
 6 Art Studios
 6 Design Technology Spaces (FABRICS, PLASTICS, ETC)
 Staff Planning and Office spaces
 Toilets

CLEAN
 2 Storey STEAM Centre
 6 Science Labs
 6 Digital Technology Spaces (VIS COM, DIGITAL TECHNOLOGY ETC)
 Staff Planning and Office spaces
 Toilets

STEAM spaces are to be delivered in two stages so the first stage will need to provide spaces that are flexible enough to cater for the whole curriculum.

Junior Secondary Science can be held in Year 7 & 8 Wet Labs until the Science facilities are delivered. The Stage 2 STEAM Centre space will be flexible enough to be configured as Art and Design Studios until the second stage specialist spaces are delivered.

ART & DESIGN



DIGITAL TECHNOLOGY



STEAM HUB SCIENCE

